

# 4201 Mc Cain Court

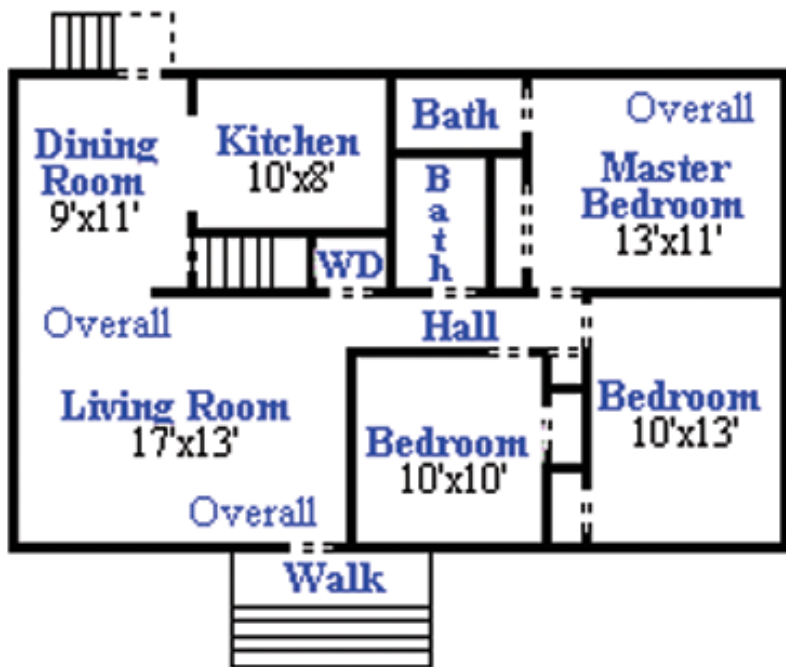

Main Level



Lower Level

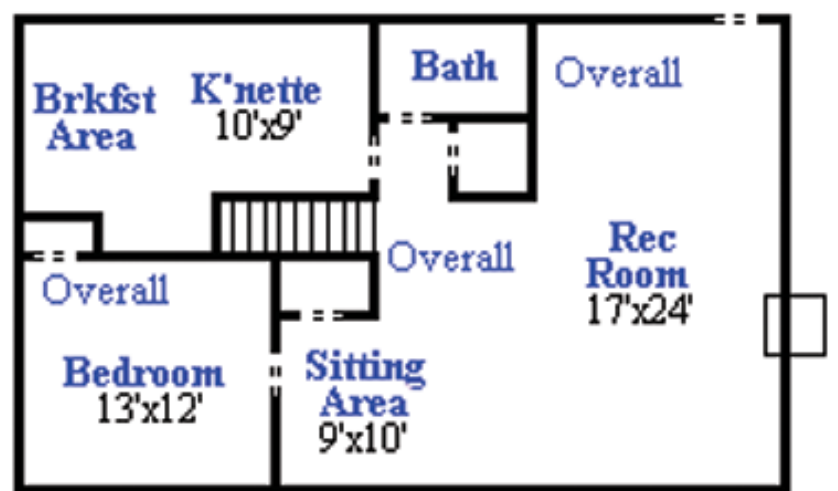

**Carole Levin**  
Direct: 301-681-4504  
Office: 301-588-1000  
[www.levinallstars.com](http://www.levinallstars.com)



## Notable Features

4 Bedrooms  
3 Full Baths  
Hardwood Floors  
Fireplace  
Off Street Parking

Corner Lot  
Separate Entrance  
to Rental Unit  
Updated Kitchen  
Updated Baths



## General Information

**Subdivision:** Rock Creek Palisades

**Lot:** 46 Block J

**Lot size:** 7,714 sq ft

**Year built:** 1955

**Taxes:** Estimated property tax and non-tax charges in the first full fiscal year of ownership is \$4,536.53

**Neighborhood:** Conveniently located 2.5 miles north of I-495. Less than 3 miles to NIH and Bethesda Naval Hospital. Walk to Rock Creek Park, close to shops, restaurants, Antique Row and just minutes to D.C.