

9319 Harvey Road

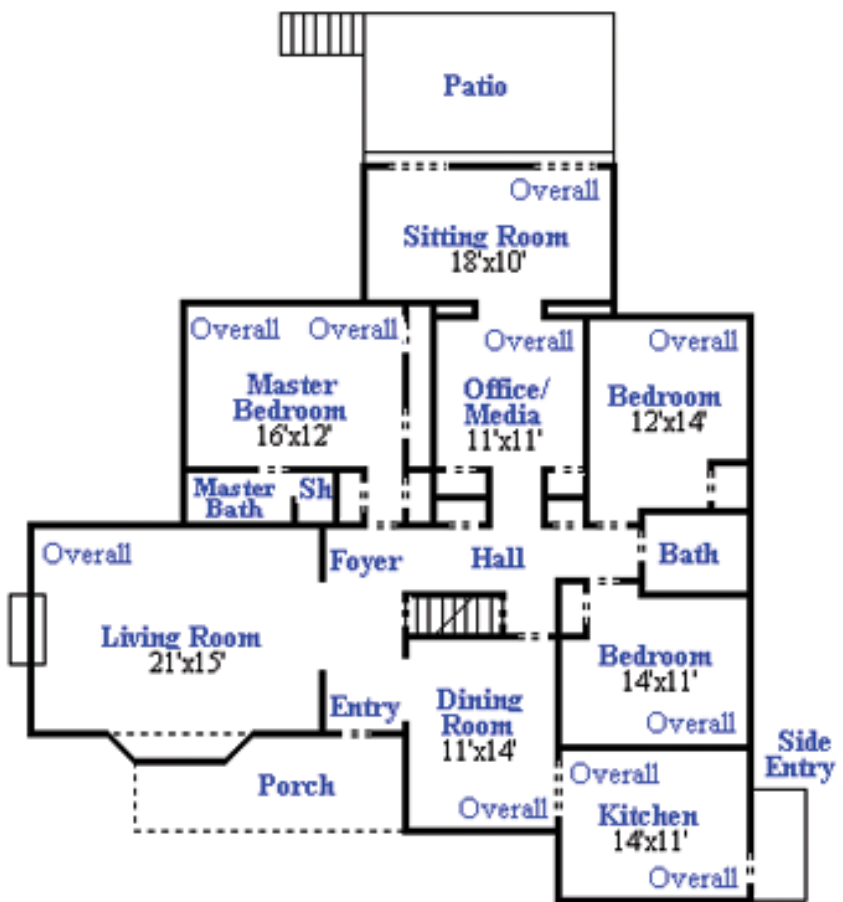

Main Level

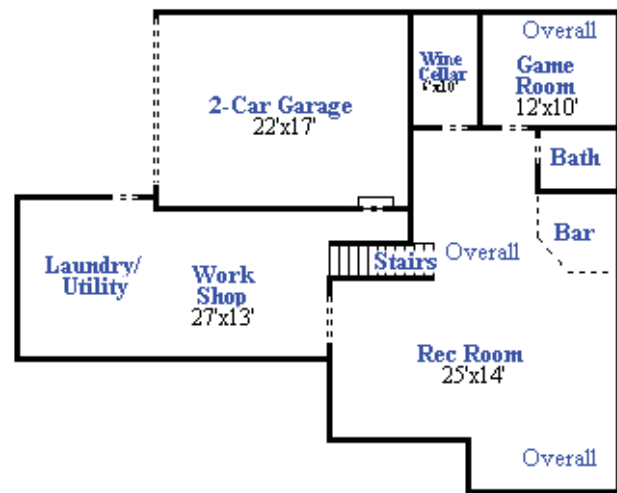

Lower Level

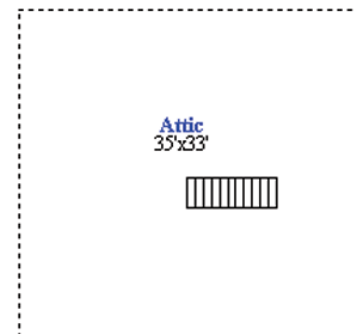

Attic Level



Carole Levin
 Direct: 301-681-4504
 Office: 301-588-1000
www.levinallstars.com





Notable Features

3,500 sq ft of Living Space
 3 Bedrooms ~ 3 Full Baths
 Huge Recreation Room ~ 1st Floor Sun Room Addition
 Lower Level Office ~ 1st Floor Library
 Fireplace ~ Hardwood Floors
 2 Car Garage ~ Fenced Backyard
 Recessed Lighting ~ Skylights ~ Energy Efficient Windows



General Information

Subdivision: Woodside Park

Lot: P2 **Block:** G

Lot size: 9,374

Year built: 1951

Taxes: Estimated property tax and non-tax charges in the first full fiscal year of ownership is \$6,542.52

Neighborhood: Close to all the amenities of Downtown Silver Spring - shops, restaurants and Silver Spring Metro. Easy access to I-495 and I-95. Steps to Sligo Creek Park with golf course, ball fields, tennis courts and jogging paths.

