

S 78° 59' 34" W 53.57  
 S 11° 00' 26" E 61.22

N 14° 37' 01" E 191.41

LOT 7  
 BLOCK O, SECTION 1  
 NORTH WOODSIDE

EXIST.  
 CONC.  
 GRAB

S 23° 16' 21" W 165.0

NEW DECK and  
 STAIRS

NEW 2 STORY  
 PLUS BSMT.  
 ADDITION

ONE STORY ADD.

EXIST.  
 PHARED  
 DRIVEWAY

EXIST. ENC. PORCH  
 TO BE REMOVED.

DRY

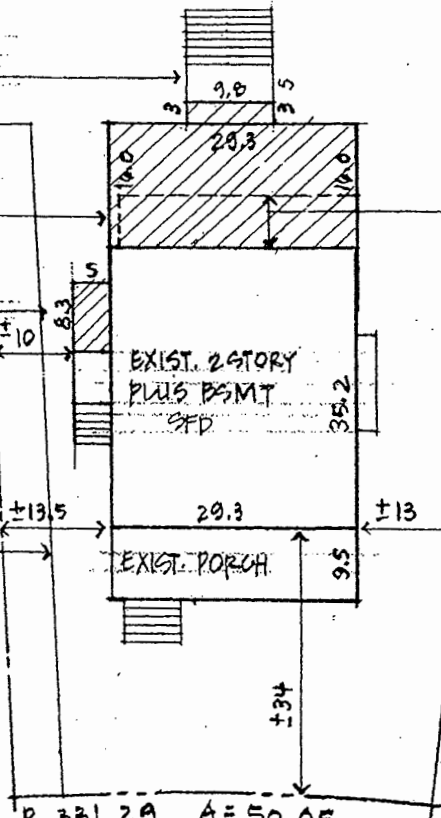

R 331.29 A = 50.05  
 LUZERNE AVENUE





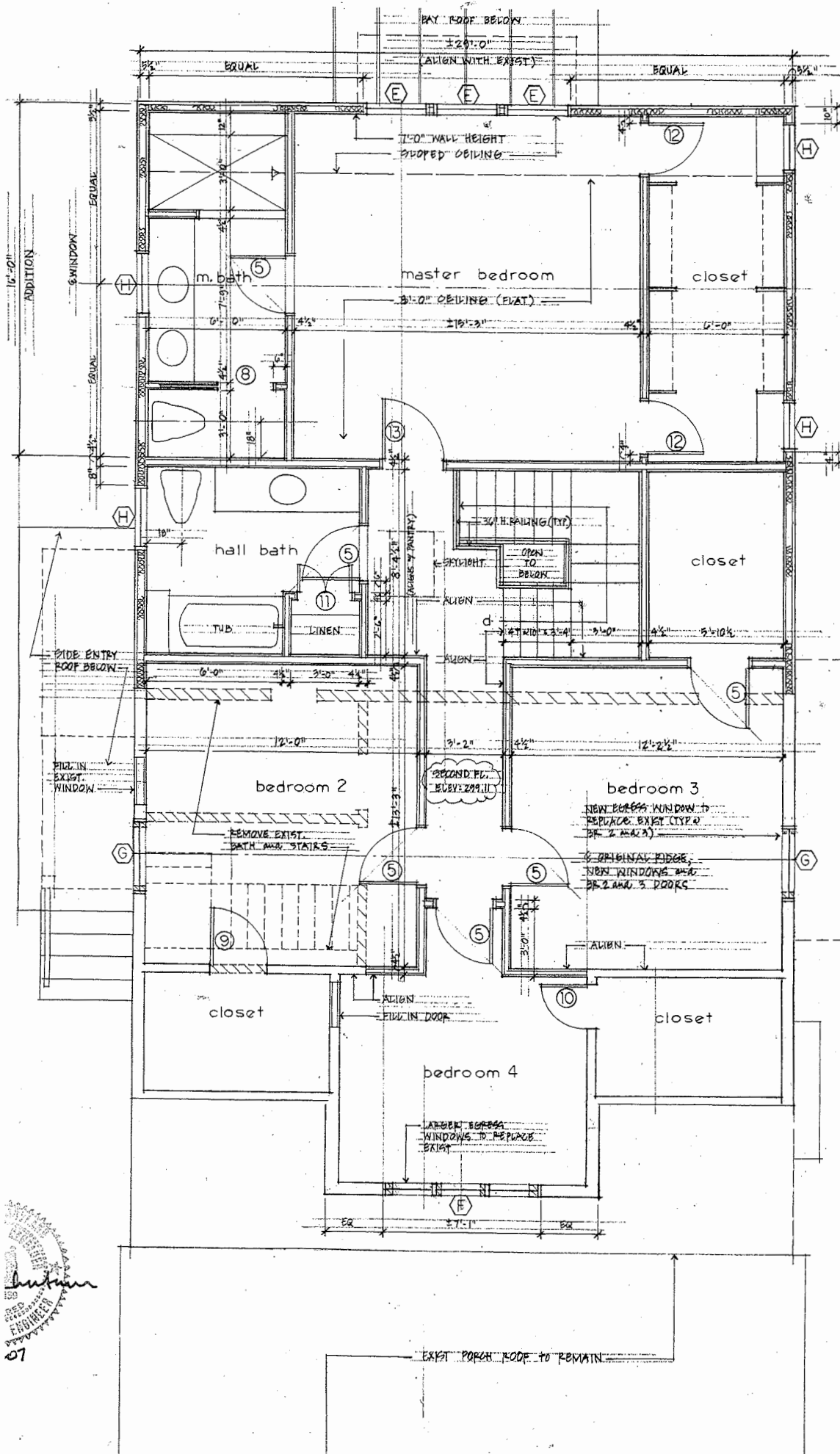

PERMIT 11-20-06  
REVISED 4-20-07

**MURDOCH ARCHITECTS**  
9208 Shelton Street  
Bethesda, Maryland 20817  
301-493-4941

**SECOND FLOOR PLAN**  
1/4" = 1' - 0"

**SINCLAIR ADDITION and RENOVATION**  
1913 Luzume Avenue  
Silver Spring, Maryland 20861

